

INSTALLATION INSTRUCTIONS

DESCRIPTION: Front A-Arm Skid Plate Kit

PART NUMBER: BG4-F31A0-V0

MODEL: '18~ Wolverine X4



⚠ WARNING

Please read and understand these instructions completely before installation to avoid possible injury, or damage to the accessory or vehicle.

WARRANTY INFORMATION:

See your Yamaha dealer for a copy of the warranty statement.

NOTICE:

This installation requires a torque wrench and should be performed by an authorized Yamaha dealer or other qualified technician.

DEALER OR INSTALLER:

These instructions contain important information for future reference and *must* be given to the customer.

PARTS LIST:

No.	Part Number	Description	Qty
--	BG4-F31A0-V0	Front A-Arm Skid Plate Kit	--
①	*	Left Side Skid Plate	1
②	*	Right Side Skid Plate	1
③	*	M6x16mm Hex Head Flange Bolt (inboard)	4
④	*	M6x25mm Hex Head Flange Bolt (outboard)	2
⑤	*	M6 Washer	6

* Part supplied with kit only and not available separately.

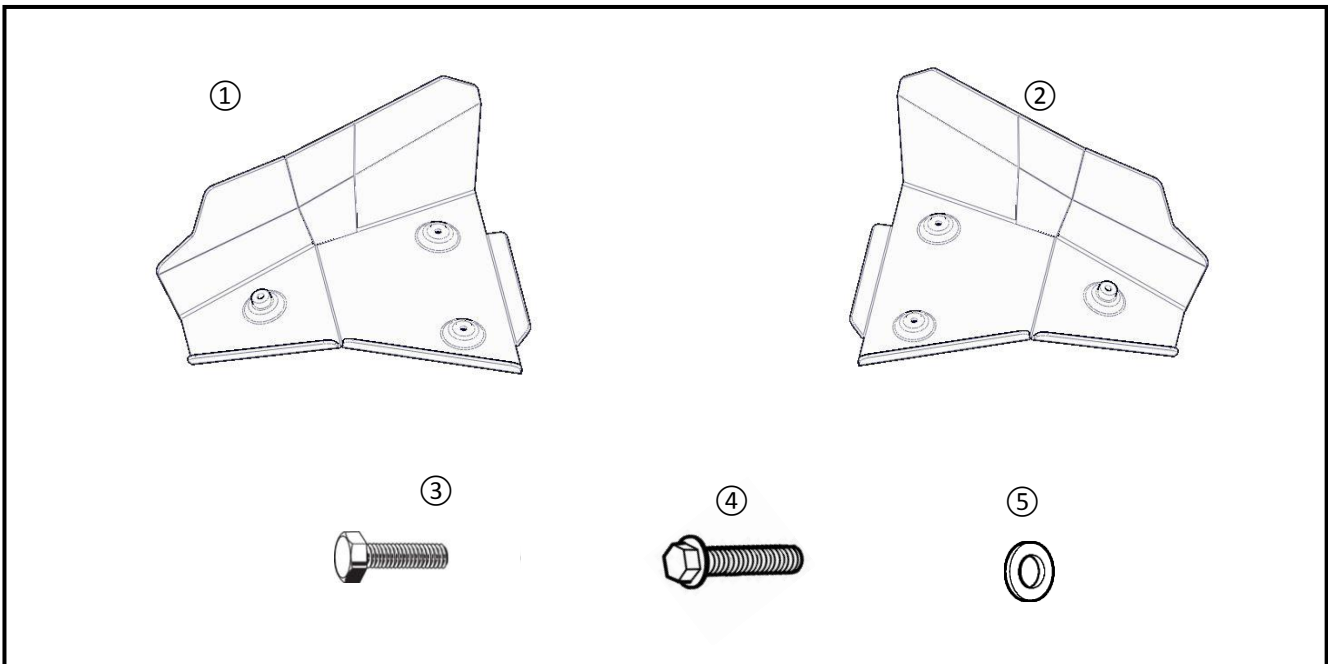

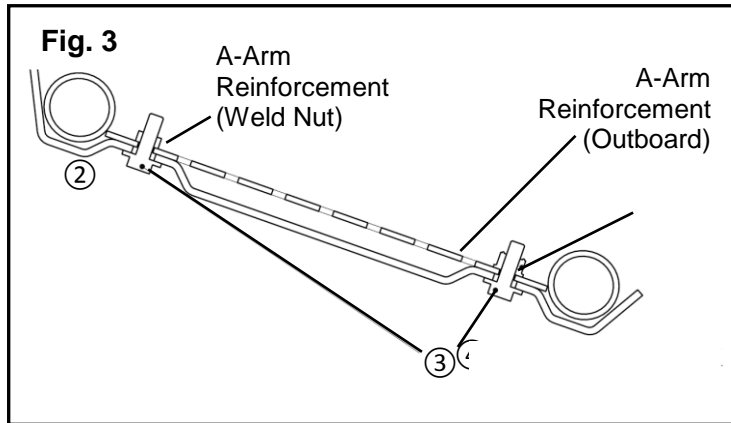
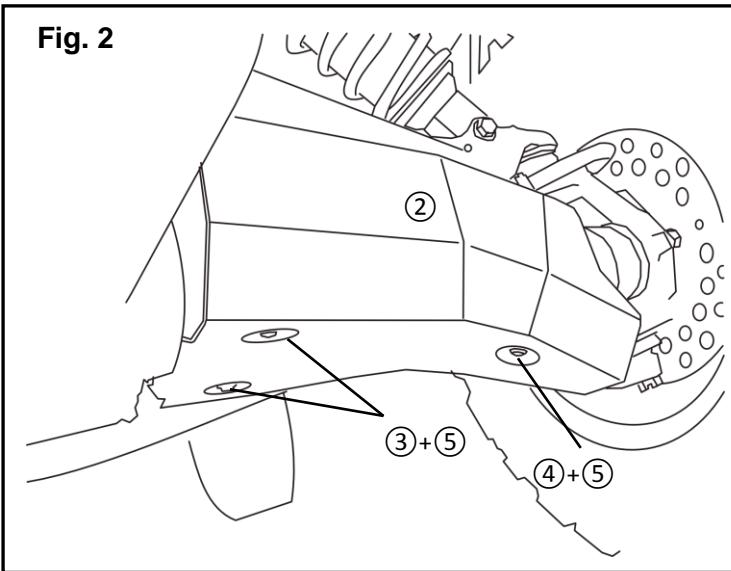
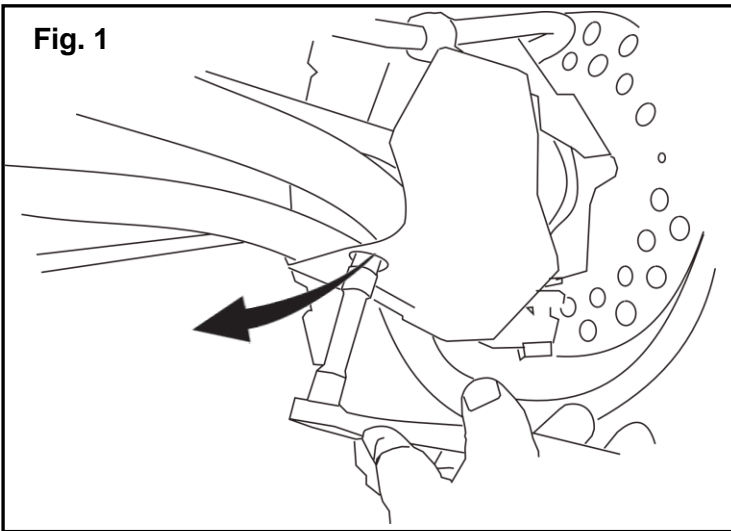

PREPARATION:

- Place the vehicle on a secure and level surface.
- Set the parking brake.
- Clean the mount surfaces before starting installation.

INSTALLATION:

1. Working underneath on the front left side, remove the 6mm bolt holding the stock plastic A-arm protector (Fig. 1). This hardware will not be reused for this installation.
2. Fit the left side skid plate (2) to the A-Arm as shown in Fig. 2.
3. On the outboard side, install a (5) Washer on to (4) M6x25 hex flange bolt. Thread the bolt into the weld nut on the back side of the A-arm. See the right side of Fig. 3.
4. Install 2 washers onto 2 (4) M6x25mm Hex Head Flange Bolt through the skid plate and into the threads of the weld nuts on the A-arm reinforcement plate. See the left side of Fig. 3.
5. Torque all three bolts to 8.5 Nm (0.85 m-kgf, 6.0 ft-lbf).
6. The installed skid plate is shown in Fig. 4.
7. Repeat the process on the right side.

MAINTENANCE:

Periodically, check torque and tightness on all hardware. If loose hardware is found, re-torque or re-tighten.

CARE AND CLEANING:

Clean metal parts with a clean soft cloth and mild soap and water. Rinse and dry.

CUSTOMER SERVICE:

For further information see your Yamaha dealer.

ESTIMATED TIME TO INSTALL: 0.3 HR

